



Radar technology to measure the level of solid powdery materials inside silos and bins.

- + Easy, wireless installation.
- + No maintenance.
- + Customisable reading frequency.
- + Long life battery power supply.
- + Recommended in dusty environments.

TECHNICAL SPECIFICATIONS

Measuring range Up to 40m.

Operating temperature From -40° to + 85°

Voltage Lithium battery 7.2 V.
Capacity 19000 mAh.

Battery life Read every 2 hours: Up to 2 years.
Read every hour: Up to 1 years.
In continuous: not recommended with battery

Sensor 60 GHz Radar.

Accuracy +/- 5 mm.

Measuring frequency Preset to 2 h, customizable.

Enclosure IP65. High density polypropylene, reinforced with fiberglass. UV treatment.

Communication Wireless. Radio frequency, free band use:
443 Mhz 868 Mhz, 905 Mhz, 922 Mhz,
depending on country.

Material Solid materials, recommended in dusty environments.

Dimensions 345 x 120 mm.

Data The data measured by Silometric can be visualized on the web platform **Digitplan**.
- Data export to a .xls file.
- Data integration with other systems using a Web Service.

OPTIONALS

Continuous reading Customizable reading.
5,5V. power supply is required in continuous reading.

DEVICE PARTS

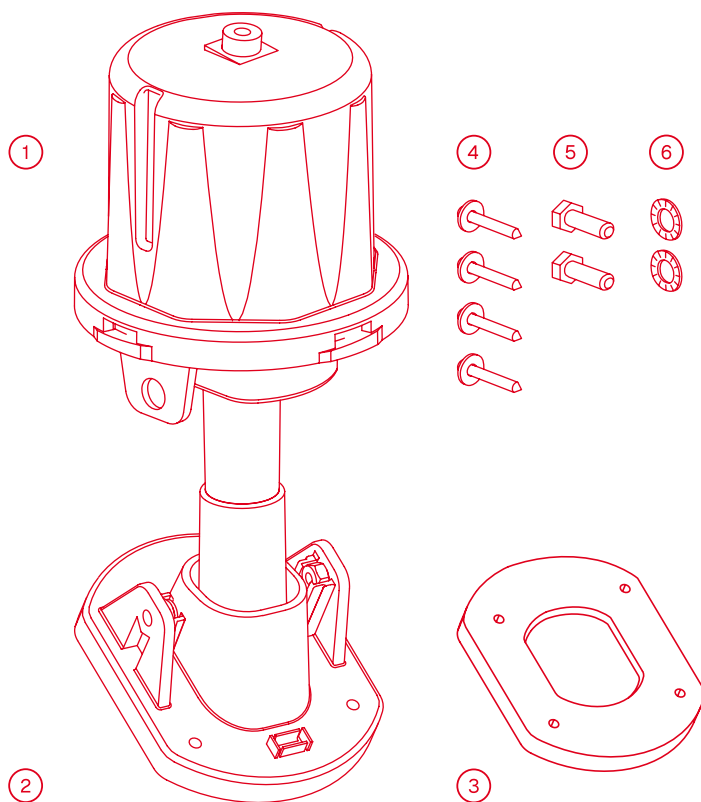

- ① Silometric Dispositive
- ② Support
- ③ Rubber gasket
- ④ Self-drilling screws 4.8 x 32 mm
- ⑤ M-6 INOX screws
- ⑥ M-6 INOX washers

Check the Installation Manual for more detailed information.

INSTALLATION

- 1.** Drill a hole in the top of the tank, it is advisable to use a drill with a 82mm bit.
- 2.** Fit the rubber gasket (3) on the lower part of the bracket (2).
- 3.** Screw the bracket (2) tightening it over the hole, presenting the device Silometric (1) with the inclination to be mounted.
- 4.** Mark the position of the bracket (2) with a pencil and mount it with the self-drilling screws (4).
- 5.** Place the Silometric device (1) into the bracket, insert the washers (6) between the Silometric device.
- 6.** Tighten the screws (5), adjust the tilt according to the level bubble and tighten to secure it.